

Classe H4 Bordo Ponte - Barriera New Jersey per manufatto W5

Class H4 Bridge side - New Jersey guardrail for bridge W5

Aufhaltestufe H4 für Kunstbauten - New Jersey Rückhaltesystem W5

Classe H4 Bord pont - Glissière New Jersey pour pont W5

Clase H4 Borde de puente - Barrera New Jersey para base puente W5

CE n. AISICO
001/CPD/2009

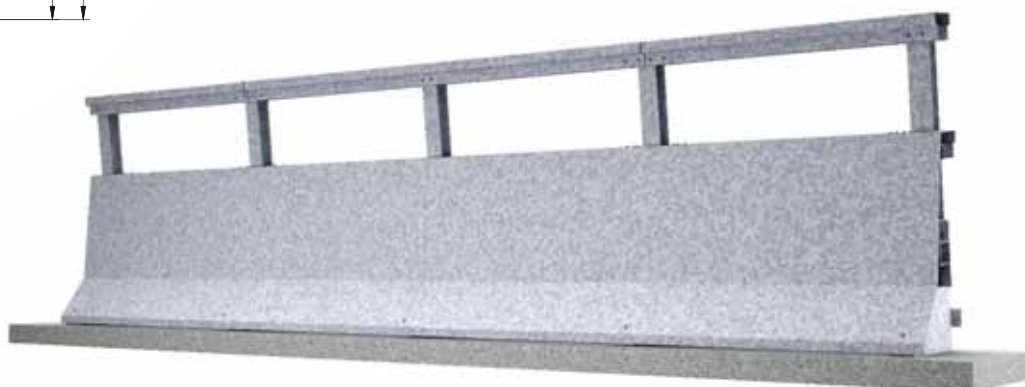
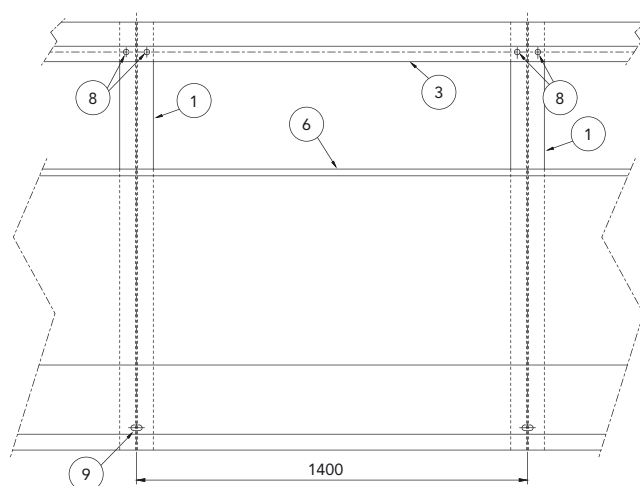
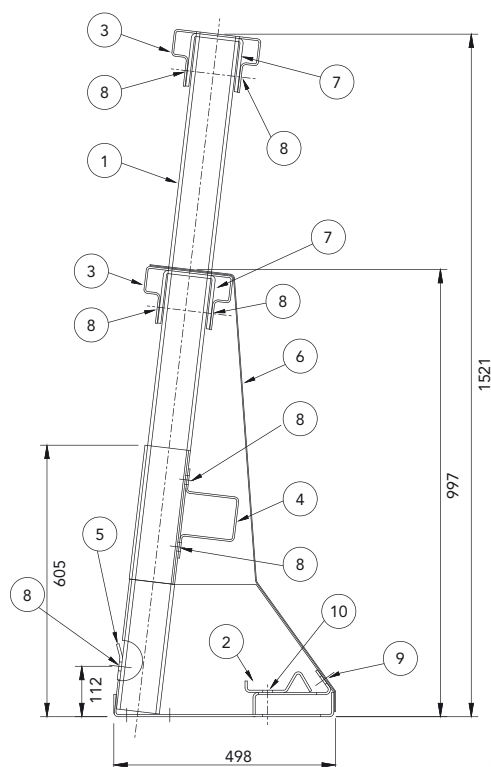

Caratteristiche Characteristics, Eigenschaften, Caractéristiques, Características

| | |
|---------------------------------------------------------------------------------------------------------------------|---------|
| Altezza fuori terra Height above ground level, Höhe über Grundboden, Hauteur hors sol, Altura sobre el suelo | 1521 mm |
| Profondità d'infissione Depth of penetration, Rammtiefe, Profondeur de piling du poteau, Longitud hincada | - |
| Ingombro trasversale Overall width, Gesamtbreite, Grosseur hors tout, Anchura total | 498 mm |
| Interasse pali Post spacing, Steherabstand, Distance entre poteaux, Distancia entre postes | 1400 mm |

Rapporti di prova Crash test reports, Testberichte, Comptes rendus d'essais, Relaciones de pruebas

| Test n. | Facility | Test | Type | Barrier length m | Mass kg | Speed km/h | ASI max 1.4 | THIV max 33 km/h | D m | Vi m | W m |
|-----------|----------|------|--------------|------------------|---------|------------|-------------|------------------|------|------|--------|
| PROVA 675 | Aisico | TB81 | Laterale 20° | 86,8 | 38.000 | 65 | | | 1,40 | 1,5 | 1,7=W5 |
| PROVA 244 | Aisico | TB11 | Laterale 20° | 86,8 | 900 | 100 | 1,4=B | 31,36 | 0,13 | | 0,8=W2 |

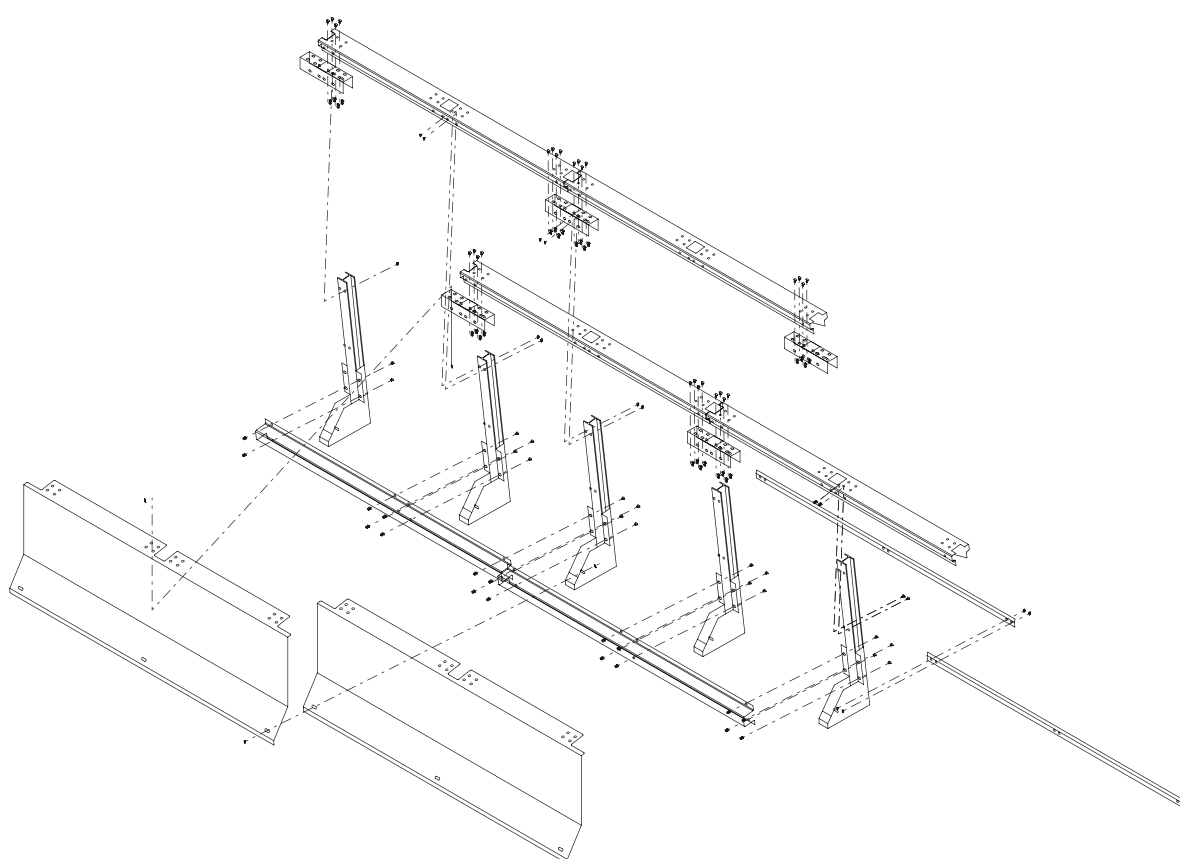

Componenti Components, Bauteile, Composants, Elementos

| | Descrizione Description | | Materiale Material | Codice Code |
|----|----------------------------------------------------------------------------------------------------------------------------------------------------------------------------------------------------------------------------------------------------------------------------------|----------------|-----------------------|-----------------|
| 7 | Profilo di collegamento Connection profile, Verbindungsprofil, Profil de raccordement, Estribo de unión | L=490 mm | S 355 JR | 59700096 |
| 6 | Mantello di chiusura Covering plate, Abdeckmantel, Plaque de recouvrement, Revestimiento de cierre | Th=2 mm | S 235 JR | 59700116 |
| 5 | Profilo inferiore Lower profile, Unteres Profil, Profil inférieur, Perfil inferior | L=2935 Th=6 mm | S 275 JR | 59700092 |
| 4 | Profilo intermedio Intermediate profile, Mittleres Profil, Profil intermédiaire, Perfil intermedio | L=2790 Th=3 mm | S 235 JR | 59700090 |
| 3 | Profilo superiore Upper profile, Oberes Profil, Profil supérieur, Perfil superior | L=2790 Th=4 mm | S 355 JR | 59700088 |
| 2 | Ammortizzatore Shock absorber, Stoßdämpfer, Amortisseur, Amortiguador | Th=5 mm | S 235 JR | 59700084 |
| 1 | Sostegno saldato Welded support, Geschweißter Träger, Support soudé, Soporte soldado | | S 275 JR | 59700111 |
| 10 | Bullone completo Bolt with nut and washer, Schraube komplett, Boulon complet, Tornillo completo con tuerca y arandela | M16x50 mm | Classe 8.8 | 63800014 |
| 9 | Bullone testa tonda esagono incassato + dado e rondella Socket head cap bolt with nut and washer, Inbusschraube mit Mutter mit Unterlegscheibe, Boulon à tête Bombée empreinte hexagonale avec écrou et rondelle, tornillo alomado con hueco hexagonal, tuerca y arandela | M16x30 mm | Classe 8.8 | 63800304 |
| 8 | Tassello maggy Maggy socket, Maggy-Ankerschraubebüchse, Tasseau Maggy, Taco maggy | M20 mm | Classe 8.8 | 63800239 |